

Gundy Road, SCONE

Lot 2 / DP 1169320

Development Application Landscape Design Report

CONTEXT PLAN

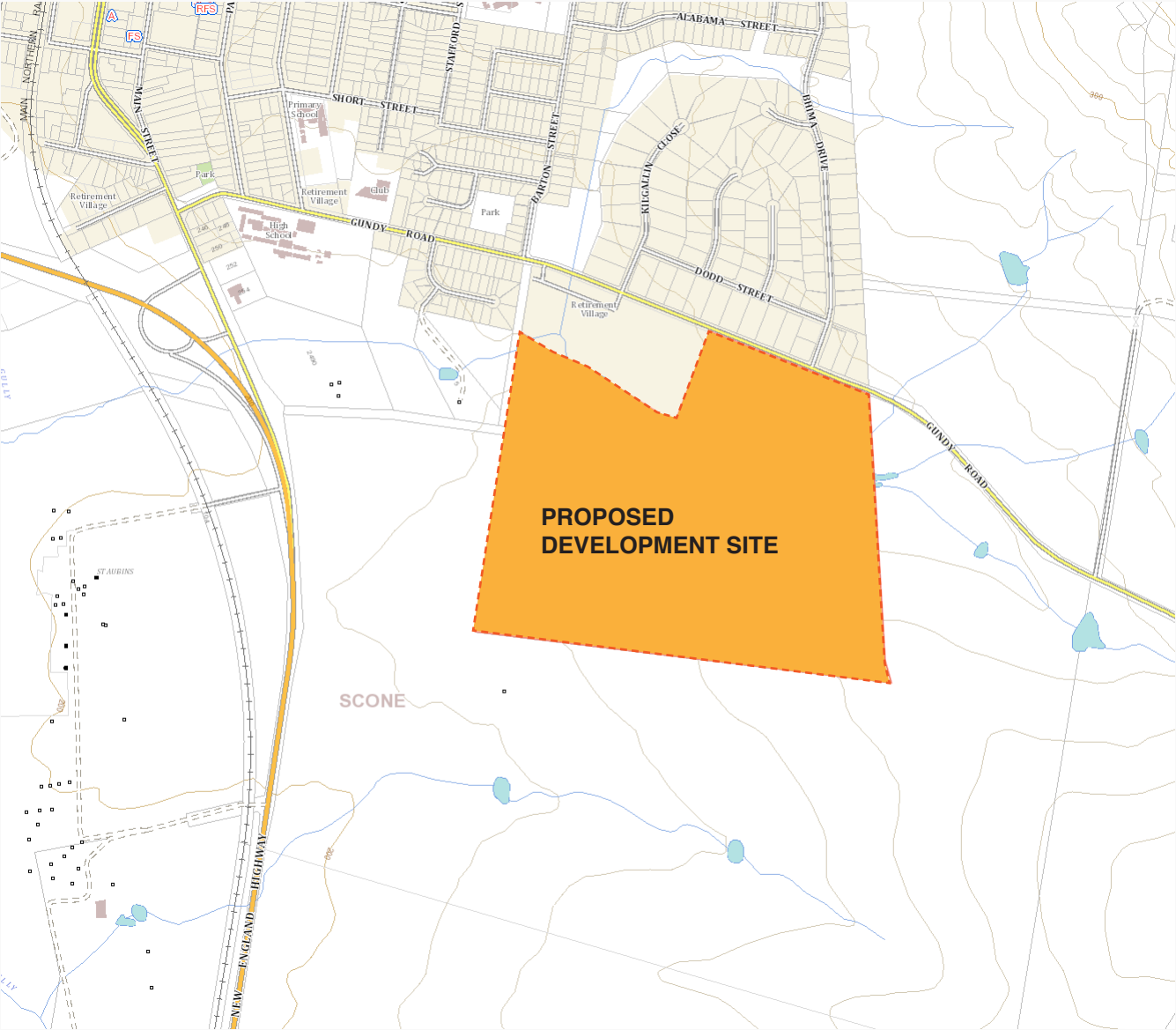

SHEET INDEX

L01	SITE PLAN
L02	STREET TREE MASTER PLAN
L03	STREET TREE SCHEDULE
L04	GUNDY ROAD FRONTAGE
L05	BOUNDARY BUFFER PLANTING
L06	BASIN PLANTING
L07	RECREATION SPACES

ISSUE DESCRIPTION

C	FOR SUBMISSION
C	FOR SUBMISSION
C	FOR SUBMISSION
C	FOR SUBMISSION
C	FOR SUBMISSION
C	FOR SUBMISSION
C	FOR SUBMISSION

DATE

17/02/2022
17/02/2022
17/02/2022
17/02/2022
17/02/2022
17/02/2022
17/02/2022



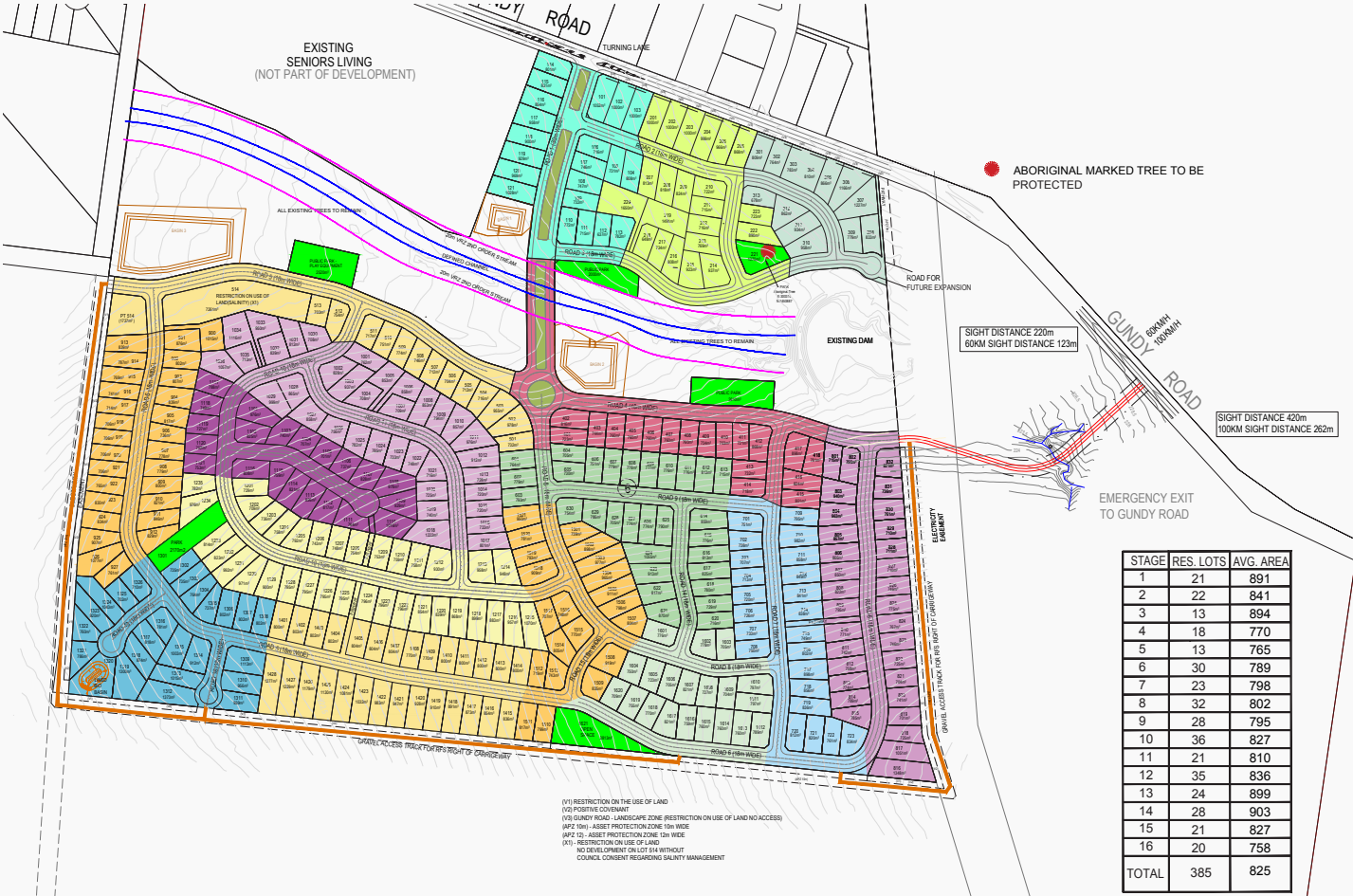











KEY PLAN





SCALE 1:4000 @ A3

LEGEND

-  SITE BOUNDARY
-  PROPOSED LOTS
Housing subject to separate applications
-  PROPOSED OPEN SPACE AND CONNECTIONS
Refer L07
-  PROPOSED MASS PLANTING
Refer L02
-  DRAINAGE RESERVE
Refer Ecologist's Report for details
-  EXISTING TREES TO BE RETAINED
Refer Ecologist's Report for details
-  ABORIGINAL MARKED TREE TO BE PROTECTED
Refer Ecologist's Report for details
-  EXISTING TREES TO BE REMOVED
Refer Ecologist's Report for details
-  PROPOSED GUNDY ROAD SCREEN PLANTING
Refer L04
-  PROPOSED 6m SCREEN PLANTING
Refer L05
-  PROPOSED 10m APZ and Fire Trail Access
Refer Bushfire Report for details
-  DETENTION BASINS
Refer L05 for Planting Details
Refer Engineer's Plans for details
-  PROPOSED FOOTPATH
-  PROPOSED VERGE
-  PROPOSED ROAD
Refer to Engineer's drawings for details



SUGGESTED PLANT SCHEDULE

Key	Botanical Name	Common Name	Pot Size	Mature Height	Mature Spread
STREET TREES					
01	<i>Acer negundo</i> 'Sensation'	Box Elder	75L	10m	8m
02	<i>Backhousia citriodora</i>	Lemon Myrtle	75L	8m	4m
03	<i>Brachychiton acerifolius</i>	Illawarra Flame Tree	75L	12m	6m
04	<i>Buckinghamia celsissima</i>	Ivory Curl Tree	75L	10m	4m
05	<i>Calodendrum capense</i>	Cape Chestnut	75L	10m	6m
06	<i>Corymbia gummifera</i>	Red Bloodwood	75L	15m	10m
07	<i>Elaeocarpus reticulatus</i>	Blueberry Ash	75L	8m	5m
08	<i>Eucalyptus piperita</i>	Sydney Peppermint	75L	20m	10m
09	<i>Eucalyptus robusta</i>	Swamp Mahogany	75L	15m	5m
10	<i>Eucalyptus sideroxylon</i> 'Rosea'	Red Flowering Ironbark	75L	15m	6m
11	<i>Lophostemon confertus</i>	Brush Box	75L	5m	4m
12	<i>Pistacia chinensis</i>	Chinese Pistachio	75L	10m	6m
13	<i>Prunus cerasifera</i> 'Oakvale Crimson Spire'	Purple-leaf Cherry Plum	75L	8m	4m
14	<i>Tristaniopsis laurina</i> 'Luscious'	Water Gum	75L	8m	4m
15	<i>Waterhousea floribunda</i> 'Green Avenue'	Weeping LillyPilly	75L	15m	9m
MASS PLANTED MEDIAN / ROUNDABOUT					
Grasses					
16	<i>Dietes grandiflora</i>	Wild Iris	140mm	1.2m	1.2m
17	<i>Westringia</i> 'Zena'	Coastal Rosemary	140mm	1m	1m
18	<i>Liriope muscari</i> 'Just Right'	Liriope	140mm	0.5m	0.5m
Groundcovers					
19	<i>Hardenbergia</i> 'Meema'	Meema	140mm	0.4m	2m
20	<i>Myoporum parvifolium</i>	Boobialla	140mm	0.3m	2m



Only tolerates light frosts

LANDSCAPE BUFFER PLANTING

Landscape Approach

- A three (3) metre vegetation corridor is proposed, for the purpose of creating a visual screen between the site and Gundy Road.
- Proposed species have been chosen for their demonstrated performance and for being hardy and low maintenance.
- The landscape treatment buffer contains a hedge line of *Acmena Smithii* 'Cherry Surprise' punctuated by *Tristaniopsis laurina* 'Luscious' and *Buckinghamia celsissima* trees alternated for visual interest.
- The property boundary fence is proposed to be lap and cap fencing, with the fence along the Gundy Road frontage to be a rural style typical post and rail fence.

PLANT SCHEDULE

Key	Botanical Name	Common Name	Mature Height	Mature Spread
Canopy Trees				
B	<i>Buckinghamia celsissima</i>	Ivory Curl Tree	8m	4m
T	<i>Tristaniopsis laurina</i> 'Luscious'	Luscious	8m	4m
Hedge				
A	<i>Acmena smithii</i> 'Cherry Surprise'	Lilly Pilly	2m	1.5m



INDICATIVE PLANTING PLAN

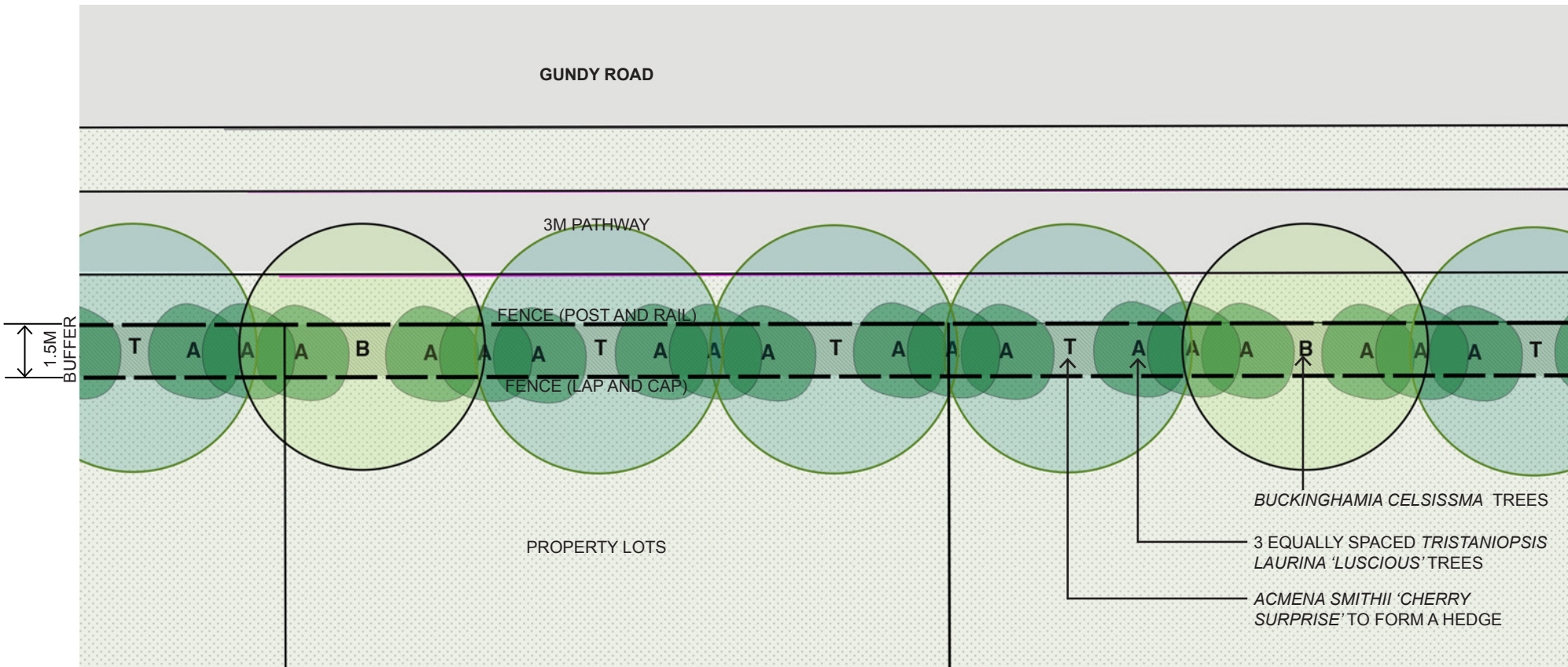

LANDSCAPE BUFFER PLANTING

Landscape Approach

- A six (6) metre vegetation corridor is proposed, for the purpose of creating a wind break and visual buffer, between the property boundary line and the Fire Trail Access (10m Asset Protection Zone). The buffer is proposed within the RU4 zoned land.
- A mix of appropriate native species is proposed, which are in line with the Ecology Report recommendations and also have low flammability characteristics. Species have also been chosen for their demonstrated ability to be sustainable within a low maintenance environment. Native species will also enhance the environmental value associated with the buffer planting.
- The landscape treatment buffer is proposed to contain a suitable combination of trees, shrubs and grasses to create a visual diversity and promote a rural woodland character.
- Retention of existing significant hollow bearing trees within the buffer is proposed.
- A staggered planting pattern is proposed in order to simulate a natural setting and be an effective wind break.

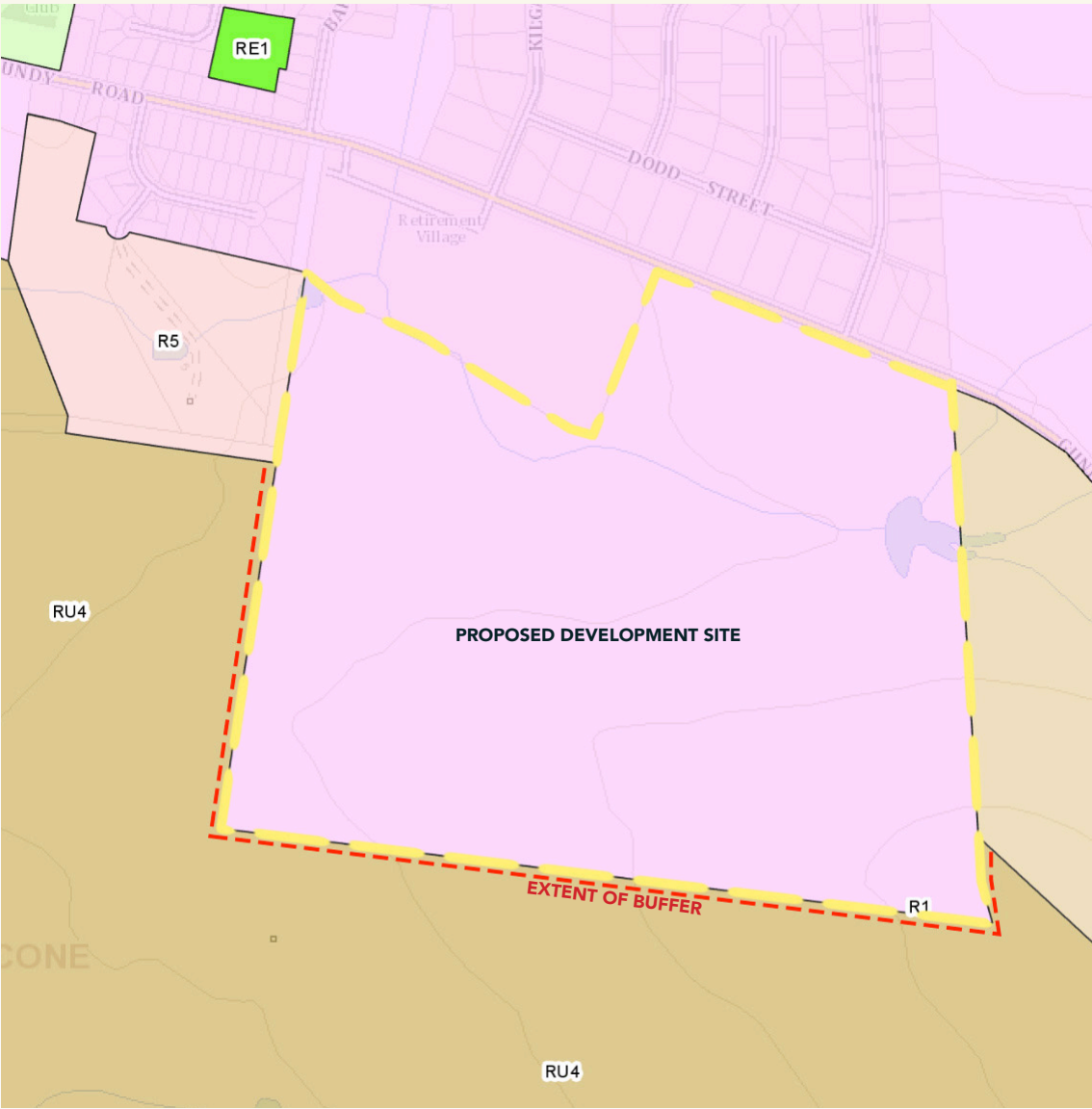

SITE PLAN

PLANT SCHEDULE

Key	Botanical Name	Common Name	Mature Height	Mature Spread
Canopy Trees				
	<i>Angophoa costata</i>	Smoothbarked Apple Myrtle	20m	12m
	<i>Tristaniopsis laurina</i>	Kanooka Gum	15m	6m
Medium Trees				
	<i>Acacia dealbata</i>	Hickory Wattle	12m	8m
	<i>Acacia implexa</i>	Hickory Wattle	8m	7m
	<i>Elaeocarpus reticulatus</i>	Blueberry Ash	9m	4m
Groundcovers and Grasses				
	<i>Aristida ramosa</i>	Purple Wiregrass	0.9m	0.5m
	<i>Austrostipa aristiglumis</i>	Speargrass	2m	1.2m
	<i>Austrostipa scabra</i>	Slender Bamboo Grass	0.6m	0.6m
	<i>Correa alba</i>	White Correa	1.5m	1.5m
	<i>Cyperus gracilis</i>	Slender Flat-sedge	0.3m	0.3m
	<i>Dianella revoluta</i>	Flax Lily	1m	0.8m
	<i>Geranium solanderi</i>	Native Geranium	0.5m	0.5m
	<i>Lomandra filiformis</i>	Mat Rush	0.4m	0.4m
	<i>Themeda triandra</i>	Kangaroo Grass	1.5m	0.5m
	<i>Wahlenbergia communis</i>	Bluebell	0.7m	0.5m

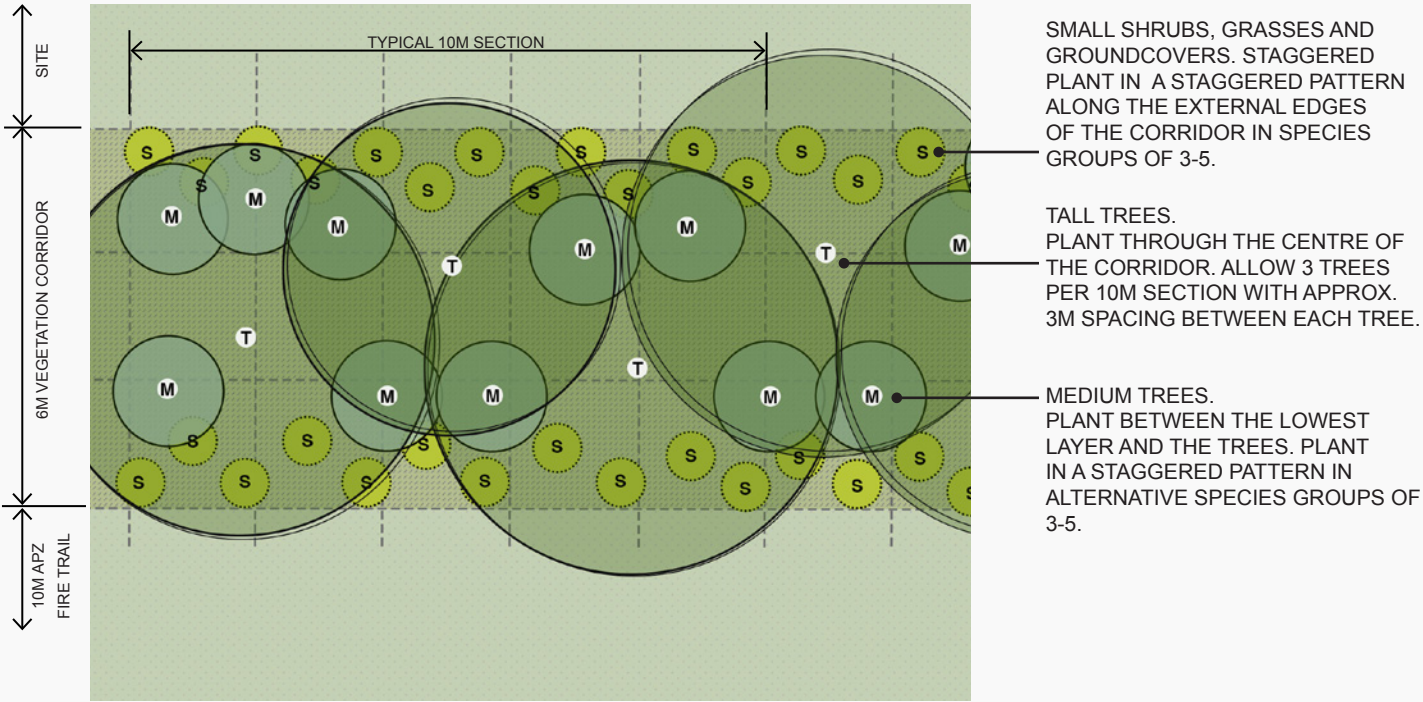

INDICATIVE PLANTING PLAN

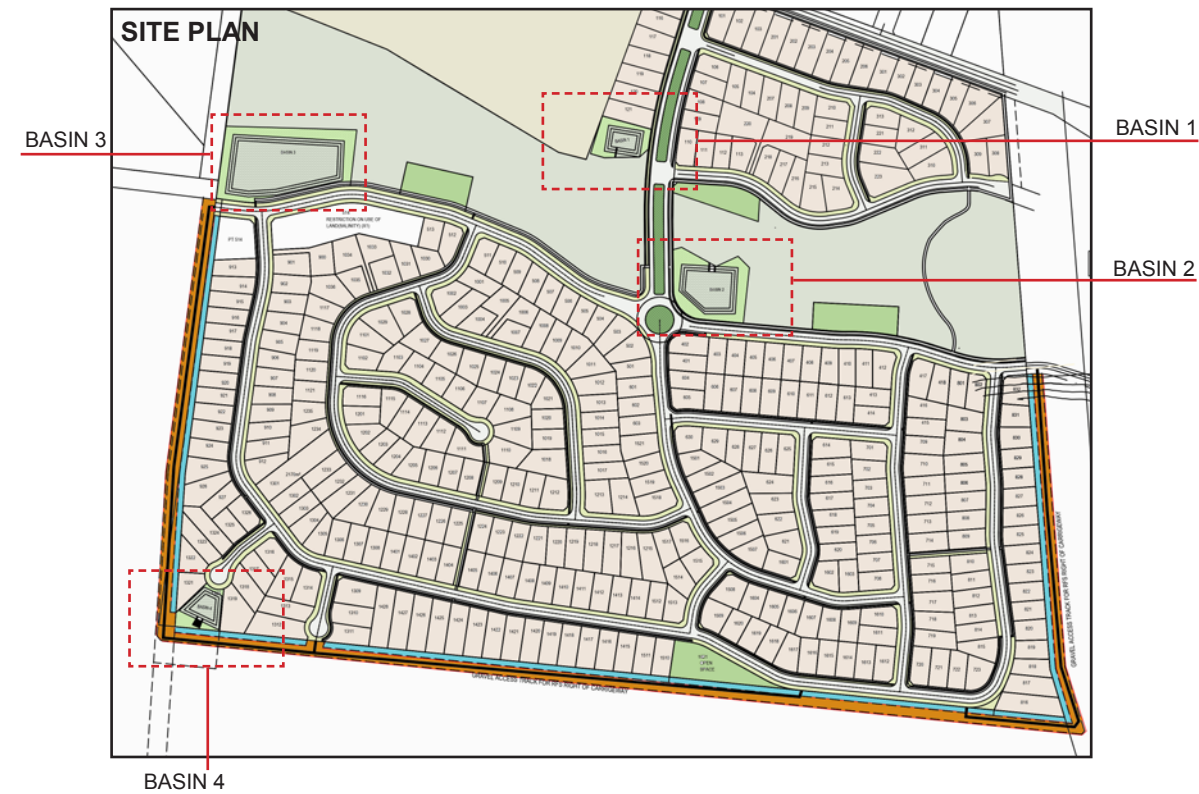

NATIVE GRASS - PLANTING SCHEDULE

BOTANICAL NAME	COMMON NAME	POT SIZE	DENSITY
<i>Austrodanthonia fulva</i>	Wallaby Grass	Tubestock	6/m ² - Plant
<i>Dichelachne micranthe</i>	Plum Grass	Tubestock	in species
<i>Echinopogon caespitosus</i>	Hedgehog Grass	Tubestock	groups of
<i>Poa labillardieri</i>	Tussock Grass	Tubestock	3-5
<i>Themeda australis</i>	Kangaroo Grass	Tubestock	

LEGEND

	HYDRO SEED MOUND TREATMENT
	COUCH TURF
	MASS NATIVE GRASS PLANTING
	REFER PLANT SCHEDULE

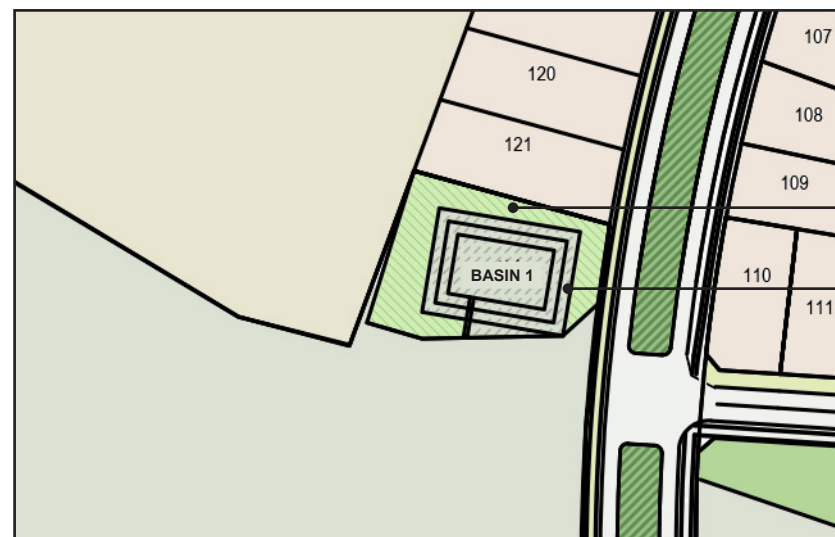

NATIVE GRASS PLANTING TO EXTENT OF PROPOSED BATTER. REFER TO ENGINEER'S PLANS FOR DETAILS AND PLANT SCHEDULE FOR SPECIES.

HYDROSEED TREATMENT (COUCH)

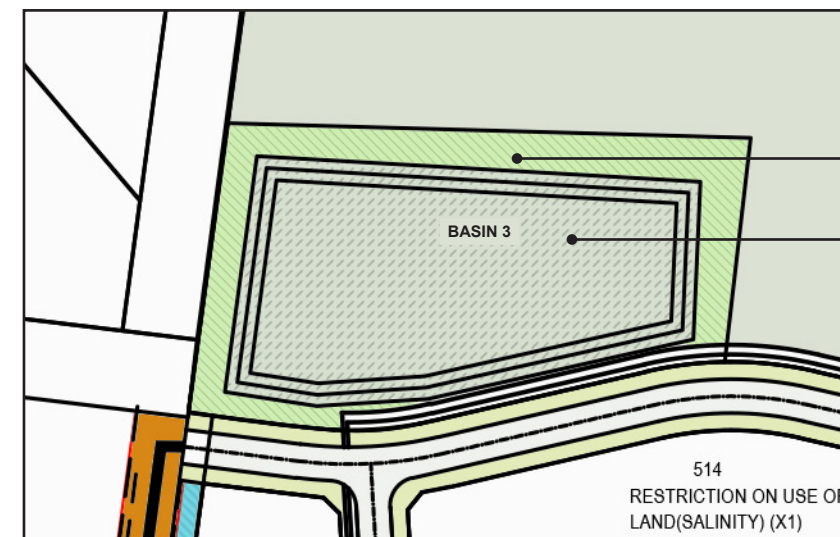

NATIVE GRASS PLANTING TO EXTENT OF PROPOSED BATTER. REFER TO ENGINEER'S PLANS FOR DETAILS AND PLANT SCHEDULE FOR SPECIES.

HYDROSEED TREATMENT (COUCH)

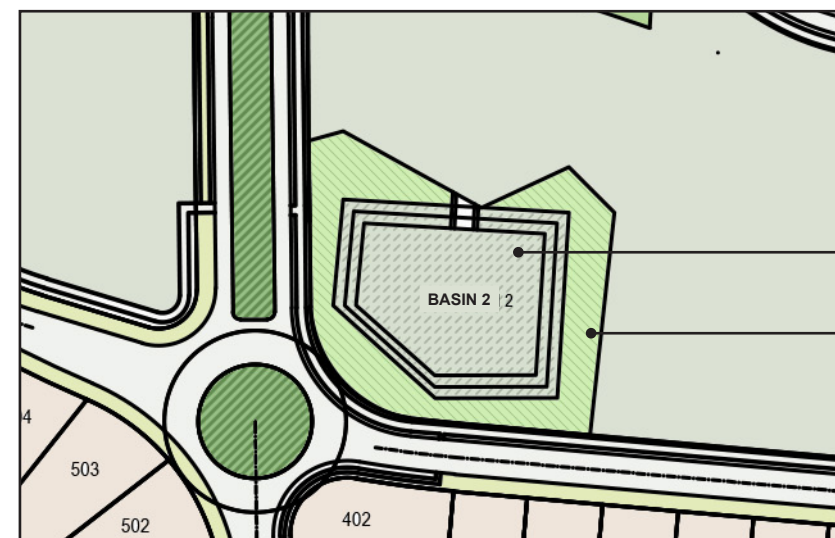

HYDROSEED TREATMENT (COUCH)

NATIVE GRASS PLANTING TO EXTENT OF PROPOSED BATTER. REFER TO ENGINEER'S PLANS FOR DETAILS AND PLANT SCHEDULE FOR SPECIES.

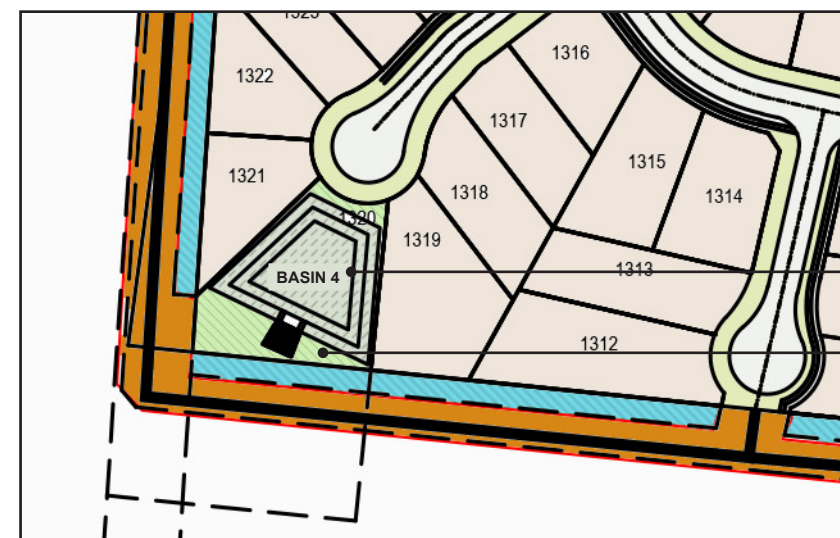

NATIVE GRASS PLANTING TO EXTENT OF PROPOSED BATTER. REFER TO ENGINEER'S PLANS FOR DETAILS AND PLANT SCHEDULE FOR SPECIES.

HYDROSEED TREATMENT (COUCH)



POTENTIAL RECREATION USE STRATEGY

THERE ARE FOUR DEDICATED OPEN SPACES WITHIN THE SUBDIVISION INTENDED FOR PUBLIC RECREATION USE. THE OPPORTUNITY EXISTS TO PROVIDE EACH OF THESE SPACES WITH A DIFFERENT FOCUS TO CATER FOR THE WIDER COMMUNITY AND GROWING DEMAND FOR QUALITY OPEN SPACE. SUGGESTED PURPOSES FOR EACH ARE AS BELOW AND WOULD BE SUBJECT TO FURTHER CONSULTATION AND DETAILED DESIGN.

01 RECREATION SPACE 1 - SPORTING RESERVE

POTENTIAL OPEN SPACE AREA TO BE USED AS A SPORTS FIELD FOR MULTIPLE CODES AND A PASSIVE RECREATION OPEN SPACE IN OFF PEAK.



02 RECREATION SPACE 2 - PASSIVE PLAY AND PLAYGROUND

OPPORTUNITY WITHIN THIS OPEN SPACE AREA TO INCLUDE AN ACTIVE PLAYGROUND AREA WITH PLAY SPACE EQUIPMENT SUITED TO 2-12 YEAR OLDS. PARK TO ALSO INCORPORATE BBQ, PICNIC TABLES AND SHELTERS.



03 RECREATION SPACE 3 - YOUTH FACILITIES

OPEN SPACE AREA POTENTIAL TO INCLUDE YOUTH FACILITIES - SUCH AS A MULTI-COURT, REBOUND WALL AND SKATE PARK.



04 RECREATION SPACE 4 - EXERCISE TRAIL

OPEN SPACE AREA POTENTIAL TO INCLUDE A WALKING AND TRIKE TRAIL WITH GYM STATIONS.

